



User Manual

Contents

1	MAIN FEATURES AND SPECIFICATION	-----	1
1-1	Main Features	-----	1
1-2	Specification	-----	1
2	PRECAUTIONS	-----	1
3	INSTALLATION AND START TO USE	-----	2
3-1	Requirements before using	-----	2
3-2	Start to use	-----	2
4	KEYPAD AND PANEL INTRODUCTION	-----	3
5	FUNCTIONS AND OPERATION	-----	4
5-1	Simple Weighing	-----	4
5-2	Tare Function	-----	4
5-3	Units Shift and Setting	-----	4
5-4	Simple counting setting	-----	4
5-5	Simple percent counting	-----	5
5-6	Hold function	-----	5
5-7	Printing function	-----	5
6	ERROR MESSAGE AND TROUBLESHOOTING	-----	6

1、 MAIN FEATURES AND SPECIFICATION

Introduction

This is a multi-function weighing balance that offer flexibility together with good features!

1-1. Main features:

- A: Automatic zero point tracking function.
- B: With multi-rang calibration.
- C: Tare function.
- D: Many units can be selection.
- E: Simple counting function and percentage function are applicable.
- F: Fast, stable and accurate display reading with simple operation.

1-2、 Specification

Capacity (g)	150-6000
Out Display	1/60000-1/150000 count
Resolution	
Display	6-7 digits LCD display with backlight/LED display
Tare	Full range of max capacity
Power supply	Rechargeable battery DC 6V/1.3AH/Adapter AC 110~220V/DC 12V/ 500mA
Temperature	Storage -10~+50℃ Work 0~+40 ℃
Humidity	Storage 5%-90% R.H Work 10%-80% R.H.

2、 PRECAUTIONS:

2-1、 Full charge the battery after unpacking the scale.

Recharge the battery: *When battery symbol appears on the LCD display, charge the battery with AC adapter, the balance of charge will light up in red, when it becomes green means charge completed. (It takes about 8 hours to full charge the battery.)*

2-2、 Install the equipment on a level and stable surface.

2-3、 Do not install the equipment near the air conditioning or a vibrating machine.

2-4、 Install the equipment in an environment with steady temperature(0℃ ~40℃), prevent from rapid temperature changes.

2-5、 Independent AC adapter for this equipment is recommended, check the

2-6、 Warm up the equipment for 15 minutes before use.

2-7、 Avoid overloading or dropping material onto the platform.

3、 INSTALLATION AND START TO USE

3-1、 Installation:

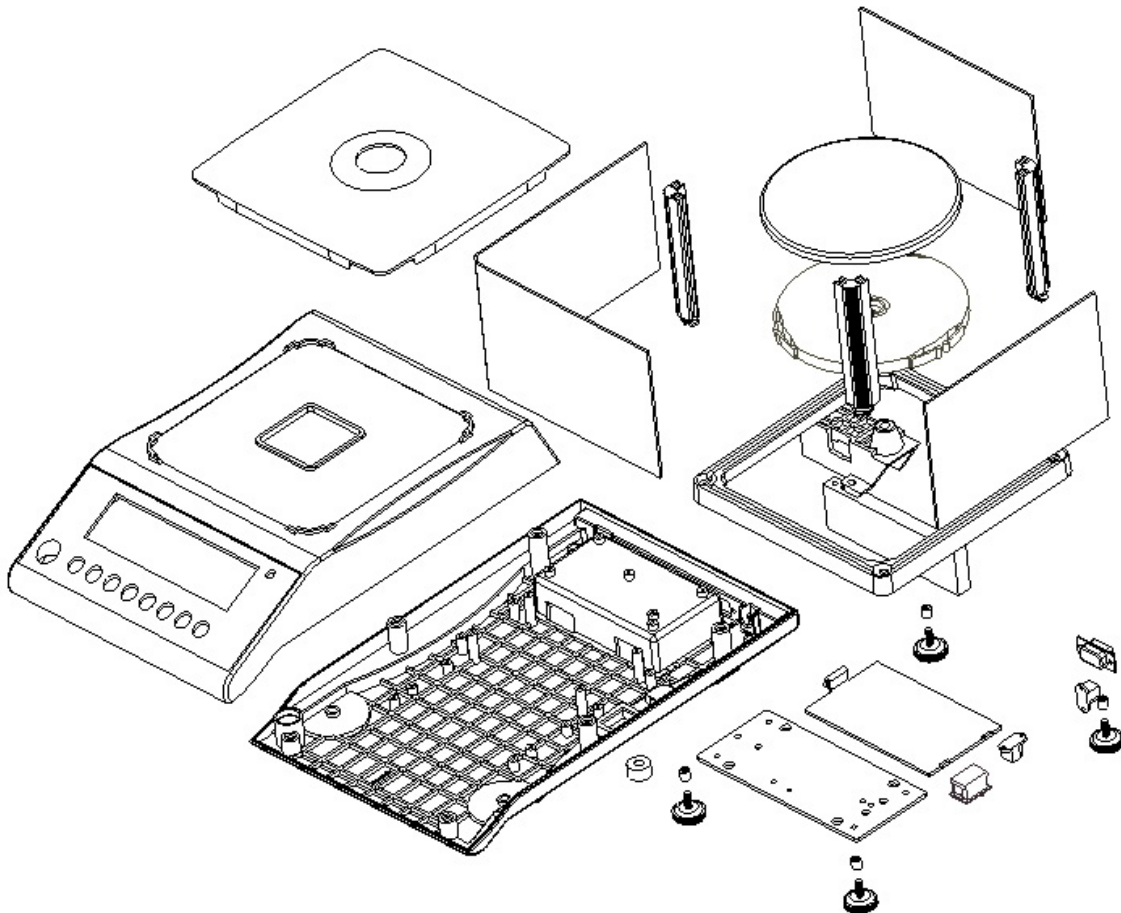

3-2、 Start to use







(1)Accessories:

- ① adapter
- ② balance body
- ③ plastic pan
- ④ SS pan
- ⑤ wind shield

(2) Turn on the indicator

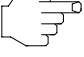
- ① Press the [ON/OFF] key.
- ② Wait till the screen displays “0.00”. If it doesn't shows “0.00”, press [ZERO] key to enter weighing mode.

4、KEYPAD AND PANEL INTRODUCTION

ITEM	OPERATION	FUNCTION
ON/OFF	 ON/OFF	Power switch
ZERO	 ZERO	Reset to zero
TARE	 TARE	Tare
UNIT	 UNIT	Change the present unit
MODE	 MODE	Change Weight/PCS/% functions
PRINT	 PRINT	Print out the data
HOLD	 HOLD	Lock the display weight value

LCD MODEL:

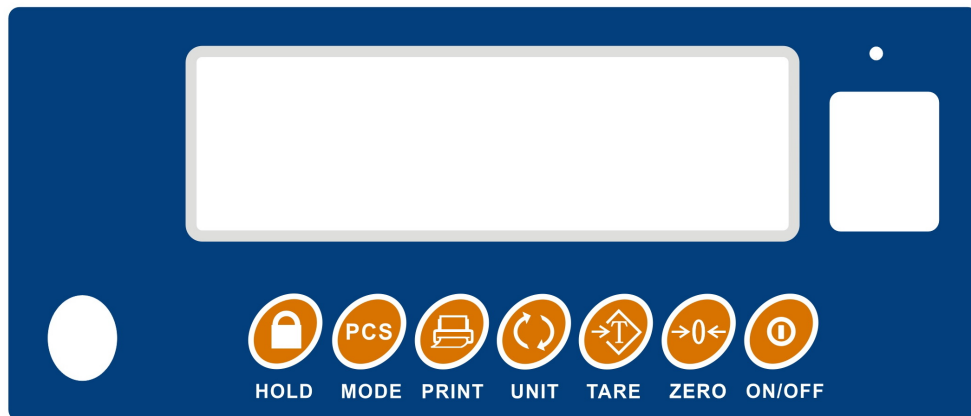

Front display pannel



Back display pannel (Optional)

LED MODEL:



Front display pannel



Back display pannel (Optional)

5、FUNCTIONS AND OPERATION

5-1、Simple weighing

- ① Press the [on/off]key or Turn on the power switch on the right side of balance.
- ② The balance power on with beep and backlight flash.
- ③ Wait till the screen displays "0.00g". Press **[ZERO]** key to enter weighing mode if the screen doesn't display "0.00g".
- ④ Put the object on weighing pan then read the weight within 2~3 seconds.

5-2、Tare funciton:

- ① Put the container (object) on weighing pan, press **[TARE]** to deduct the container(object) weight, the screen displays "0.00g".
- ② Put more objects on the weighing pan, the screen displays weight of new objects excluding weight of container.

5-3、Units shift and setting

Under weighing mode, press **[UNITS]** key to change to the unit you need. Open more units or close any units, please contact your local agent.

5-4、Simple counting setting

- ① Under weighing mode, press **[PCS]** choose the simple counting function. Put on the weights, if no unit weight setting before, screen will display "0 pcs".

- ② Press **[UNIT]** key, enter quantity setting, The screen displays “ N-XXX”
(“XXX” stands for sample quantity.)
- ③ Press **[UNIT]** key, move the digit.
- ④ Press **[TARE]** key, add up the percent digits.
- ⑤ Press **[ZERO]** key, reduce the percent digits.
- ⑥ Press **[PCS]** key, save the above setting, you can begin to use this function.

5-5、 Simple percent counting

In counting mode, press **[MODE]** to change % mode or weighting mode.

- ① Under weighing mode, press **[MODE]**, choose the % function. Put on the weights, screen will display “ S-100 %”.
 - ② Press **[MODE]** key, save the above setting, you can begin to use this function.
- *** LED model do not have % mode, so only change to weighting mode.

5-6、 Hold function

- ① Press once to lock the percent weight value.
 - ② Press again to cancel lock status.
- *** This function usually set to close, if you want to use this function, please contact your local agent.

5-7、 Printing function

connect the balance with PC or printer, this function is effective.

Under weighing mode, press the **[PRINT]** key to print out percent weight value.

5-8、 Simple calibration

Attention: Essential to use the standard weight.

- ① Under weighing mode, press **[TARE]** key 2 seconds to enter simple calibration.
- ② Press **[UNIT]** to move the digits.
- ③ Press **[TARE]** key, add up the percent digits.
- ④ Press **[ZERO]** key, reduce the percent digits.
- ⑤ Put on the right weights (the same as the display weight.)
- ⑥ Wait the stable symbol appears for 2 seconds.
- ⑦ Press **[MODE]** key, the buzzer will send out a short beep, that means simple calibration successfully.

6、ERROR MESSAGE AND TROUBLESHOOTING

1、Error message

Message	Problem
ADO---	Over A/D resolution range
ADL---	Low A/D resolution range
OVR---	Over load (max: capacity +9e)
Battery symbol	Low battery alarm
Lo-bAt	Low battery, Need charge

2、Trouble shooting:

Where	Possible Error message	Trouble shooting.
Power on	ADO---	Check and remove the object from weighing pan or send back for repair.
Power on	ADL---	send back for repair.
Power on	Battery symbol	Charge the battery.
Normal weighing mode	OVR---	Check if weighing object over the capacity +9e.
Normal weighing mode	Lo-bAt	Charge the battery.

Call your agent here:

